

20 | Water Design System

07 | WATER ANIMATIONS



Soothing sound effects

Harmonious and amusing spectacle

Pool decoration and personalisation

Overall pool enhancement

Water Design System

WATER ANIMATIONS

In its natural state water is an odourless, tasteless and colourless element, nonetheless it is a source of incomparable blessings and benefits. It has many virtues: soothing, therapeutic and purifying water is as good for our bodies as our minds.

In a warm bath, Spa, swimming pool or the sea, the water wraps around us, cradles us, takes us back to carefree days of childhood. The body is relaxed, the mind calm, so why not take more advantage of this return to favour of the therapeutic virtues of water?

A real fashion phenomenon, water features and other massage jets are particularly popular with pool owners.

Their value is twofold: hydromassage has a refreshing, relaxing and toning effect and the sound of the jets on the water is enjoyable and soothes the senses.

 **Polaris**
Water Design *System*



Polaris PowerFall

What is more restful than the gentle murmur of a waterfall? Indeed, water has proven relaxing effects. And while stimulating the senses, the water from the Polaris PowerFall creates wellbeing and peace of mind.

This fabulous fall of water also – and above all – provides a spectacle that delightfully enhances every pool. Any pool can be personalised easily and rapidly, as the PowerFall water blade is powered by the filter outlet circuit.

And to complete your pleasure, Polaris always supplies a top-of-the-range product:

- “A quality product for faultless laminar flow”
- “PowerFall is the first waterfall in ABS.”
- “Strength ensured by its patented X-baffle reinforcement”

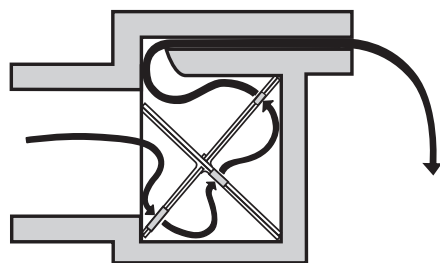

X-Baffle System

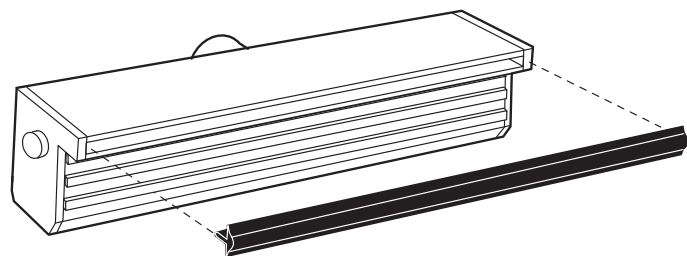

Lastly, since PowerFall is your partner in the enhancement of your pool, why place limits on your creativity? Because PowerFall is available in 3 sizes to enable you to turn even your most original ideas into reality.

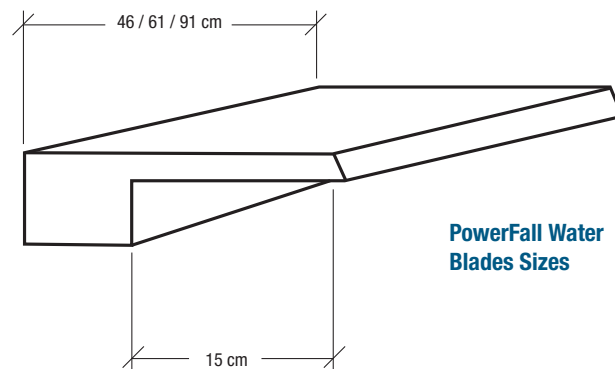

**PowerFall Water
Blades Sizes**

| Reference | Description | € / Unit |
|-----------|-----------------------------|----------|
| FFWS 18-6 | 18" Powerfall (46cm x 15cm) | 234,00 |
| FFWS 24-6 | 24" Powerfall (61cm x 15cm) | 252,33 |
| FFWS 36-6 | 36" Powerfall (91cm x 15cm) | 322,96 |
| MA50500 | USA/EU Adapter (necessary) | 3,80 |

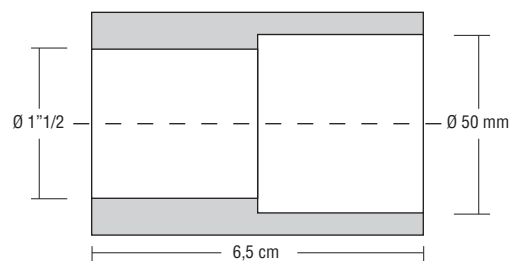

USA/EU Adapter

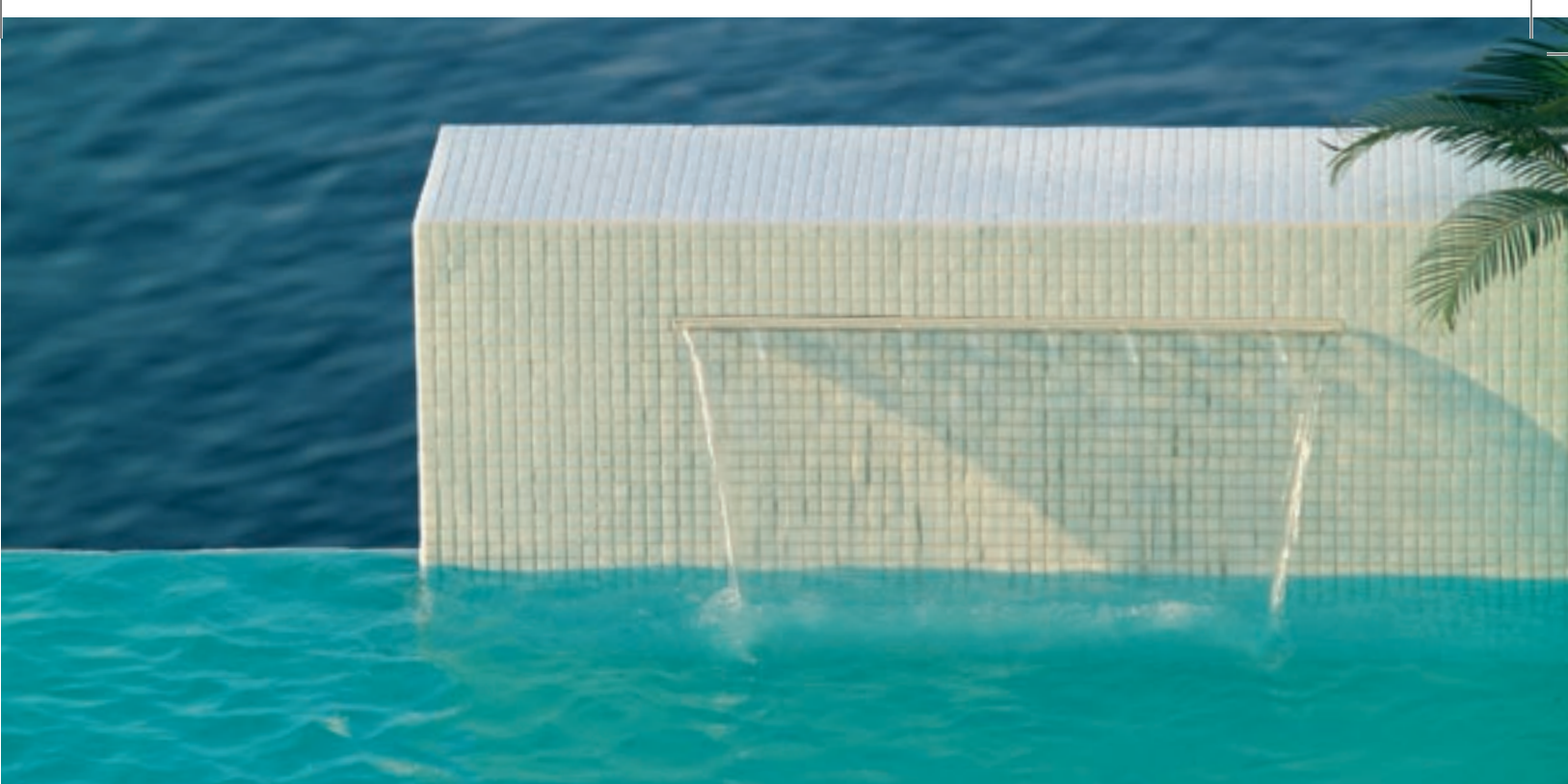

POWER/FLOW EQUIVALENTS

| | |
|--------|----------------------|
| 3/4 CV | 12 m ³ /h |
| 1 CV | 15 m ³ /h |
| 1,5 CV | 22 m ³ /h |
| 2 CV | 30 m ³ /h |

POLARIS POWERFALL BLADES: OPTIMUM OUTPUT PER FALL

| | | |
|---------------|-----------------------|---------------------------|
| PowerFall 18" | 4 m ³ /h | Maxi 8 m ³ /h |
| PowerFall 24" | 5,5 m ³ /h | Maxi 10 m ³ /h |
| PowerFall 36" | 8 m ³ /h | Maxi 16 m ³ /h |

THE PIPEWORK REQUIRED MUST BE ADAPTED TO THE WATER OUTPUT

| | |
|---------------------------------|-------|
| < 13 m ³ /h | 50 mm |
| 13 < ... < 22 m ³ /h | 63 mm |
| 22 < ... < 31 m ³ /h | 75 mm |



The Polaris Water Blades: Easy Installation

To ensure your waterfall works perfectly and provides an optimum performance, the flow of water has to be continuous and even. If the flow demand goes over 40% of the circulating pump output, you will need to use another pump and waterfall-dedicated pipework.

Installation

Important: the waterfall should not be installed at more than 1.20 metres from the water level.

- 1 | Place a separate valve on each blade. If the blades are the same size and installed at the same height, put in a loop to even the water flow over all of them.

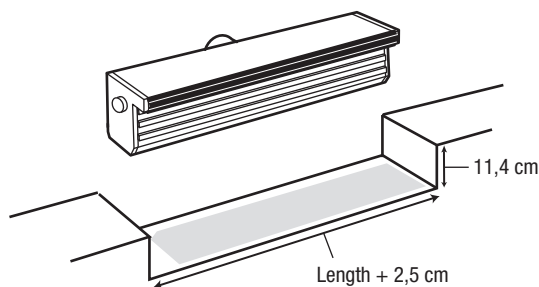
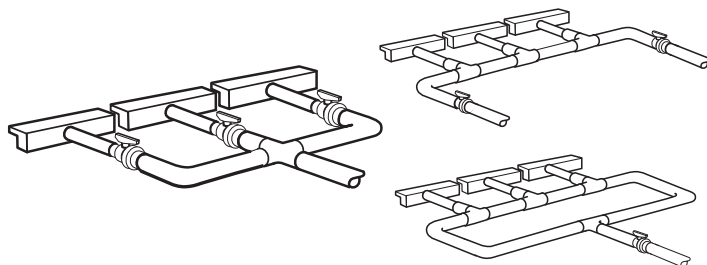

- 2 | Preparing the recess for the blade: cut a recess in the beam about 11 cm deep and 2.5 cm longer than the length of the blade selected.

- 3 | Installing the waterfall: lay a bed of mortar in the recess to reinforce the base of the waterfall. Place the blade in the water and level it off.

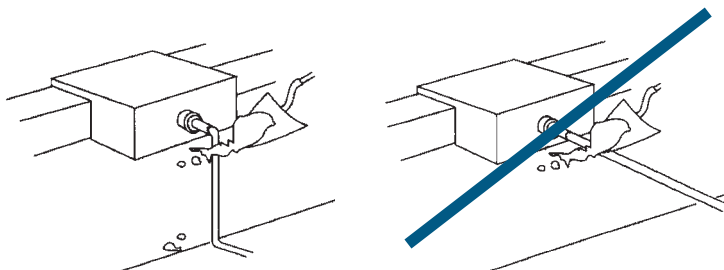
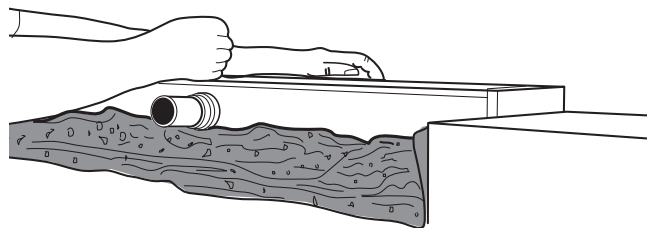

Installation of the Water Blades

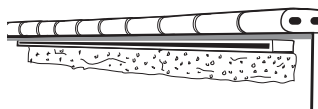

Completed Installation: Front View

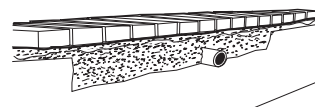

Completed Installation: Rear View

PolarisWaterStars

All the magic and delight of a pool fountain with Polaris WaterStars.

Placed in the centre of the pool, these fountains will create an attractive and soothing world. Polaris Fountain Models can be adjusted for a variety of sound and visual effects.

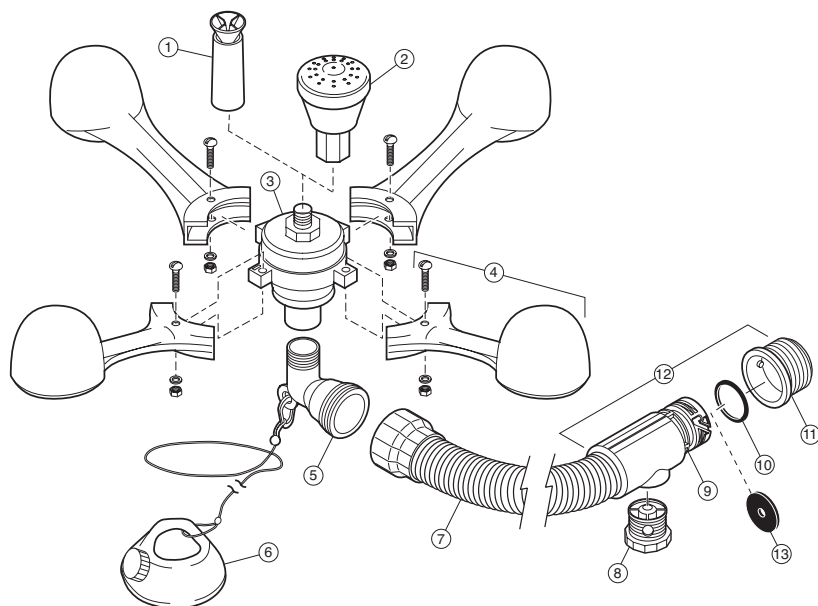

| No. | Reference | Description | € / Unit |
|-----|-----------|------------------------------|----------|
| 1 | 7-240-00 | Fountain Head, Glory | 38.08 |
| 2 | 7-230-00 | Fountain Head, 3-Tier | 68.62 |
| 3 | 7-225-00 | Central Assembly | 18.09 |
| 4 | 7-200-00 | Pod | 29.67 |
| 5 | 7-260-00 | Elbow | 6.93 |
| 6 | 7-270-00 | Anchor Assembly | 20.54 |
| 7 | 7-310-00 | Hose Kit, 10' | 31.21 |
| 8 | 11-203-00 | Adjustable Plug, UWF | 6.38 |
| 9 | 6-502-00 | Quick Disconnect, UWF | 10.67 |
| 10 | 6-505-00 | O'Ring, UWF/QD | 2.33 |
| 11 | 6-500-00 | Universal Wall Fitting (UWF) | 5.34 |
| 12 | 7-295-00 | UWF Connector Assembly | 36.73 |
| 13 | 11-103-00 | Restrictor Washer | 1.84 |

Water Design System

WATER BLADES + OPTICAL FIBRES

Polaris FiberFall

A variant of the Polaris PowerFall, the magnificent Polaris FiberFall cascade is ideal for those who wish to have more effects in their pool and enjoy its full splendour after dark. Using advanced fibre optic technology, the Polaris FiberFall illuminates cascades passing through every shade of colour. Simple and quick to install, the FiberFall can be discreetly tucked out of sight: the fibre optical connections are undetectable and the light from the column of water never reveals its secret. With FiberFall, the beauty of a son et lumière show makes every pool magical!

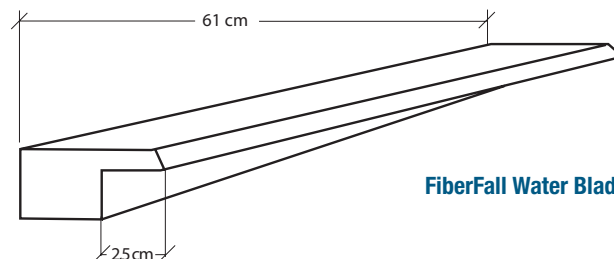

FiberFall Water Blades Sizes

| Reference | Description | € / Unit |
|-----------|--------------------------------|----------|
| FFWS 24L* | 24" Fiberfall (61 cm x 2,5 cm) | 531,37 |
| MA50500 | USA/EU Adapter (necessary) | 3,80 |

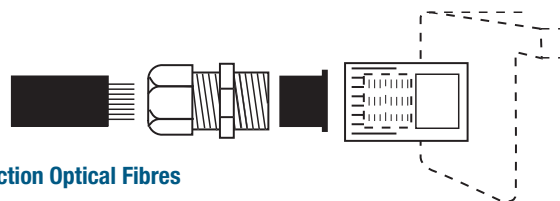

Connection Optical Fibres

Installing the FiberFall blades: cut a recess in the beam about 11 cm deep and 15 cm longer on the left than the length of the blade to house the lens chamber and the optical cable.

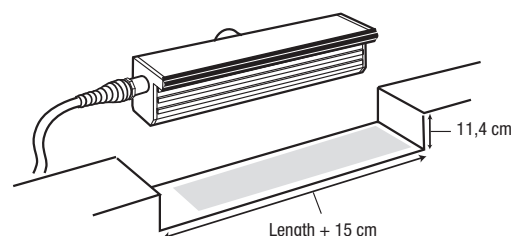

Water Design System

 **Polaris** AfterDark



Ref. AD150I 220 v

Light driver

150 W, 9 colours

Sizes:

H 50 cm x P 40 cm x L 30 cm

Weatherproofing: it is advisable to install the generator outside the plant room.

1 028,35 €

| Reference | Description | €/ Unit |
|-----------|---|----------|
| AD79500 | Roll of optical fibre all round 9 mm Ø, 150 m. long (equivalent to 150 strands) | 8 076,37 |

For other sizes, see Special Order.

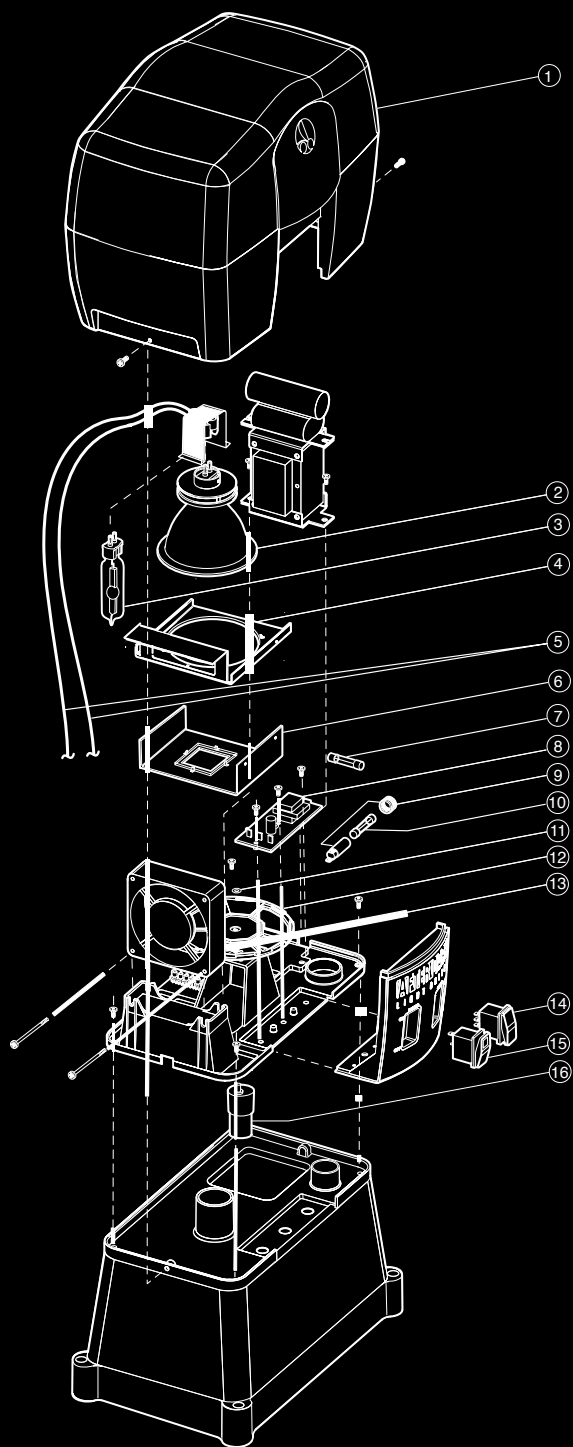

| No. | Reference | Description | €/ Unit |
|-----|-----------|---------------------------------|---------|
| 1 | AD210 | Cover | 121.91 |
| 2 | AD300 | Lamp/Reflector Assembly | 495.74 |
| 3 | AD305 | Lamp Only, 150 W H.I.D | 239.74 |
| 4 | AD310 | Lamp Bracket | 25.39 |
| 5 | AD325 | Lamp Wire/Socket Assembly | 40.30 |
| 6 | AD320 | Heat Filter Assembly | 86.55 |
| 7 | AD435 | Fuse, Color Wheel | 4.07 |
| 8 | AD430 | Color Wheel Control Board | 101.59 |
| 9 | AD640 | Fuse Holder, Main Power | 6.10 |
| 10 | AD650 | Fuse, Main Power | 4.07 |
| 11 | AD410 | Color Wheel Retainer | 4.07 |
| 12 | AD400 | Color Wheel Assembly | 424.10 |
| 13 | AD630 | Fan | 79.36 |
| 14 | AD620 | Switch, Color Wheel Power 3-way | 26.94 |
| 15 | AD610 | Switch, Main Power 2-way | 33.11 |
| 16 | AD420 | Color Wheel Motor | 102.72 |
| 17 | AD500 | Color Wheel Power Connector | 10.16 |
| 18 | AD100 | Manifold Assembly | 115.00 |

SPECIAL PARTS

| Reference | Description | € / Unit |
|-----------|--|----------|
| AD10 | UFL Water Proof Lens Housing, Universal, 1-1/2" MIP | 81.27 |
| AD27 | Hot Knife for Fiber Termination 220 v | 154.29 |

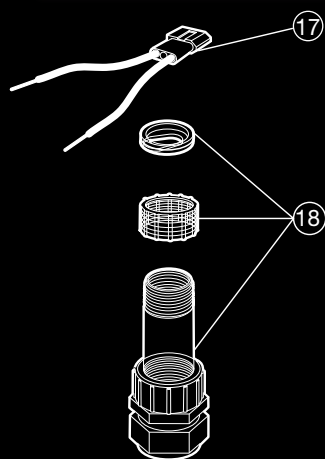

Water Design System

 **PolarisAfterDark**

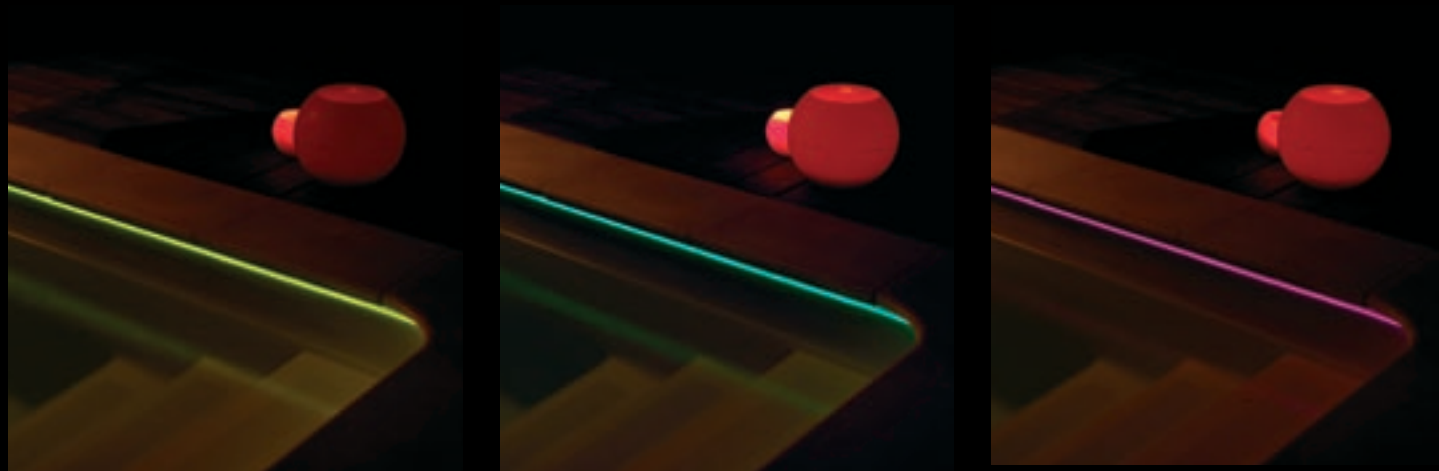

**Afterdark, the Polaris fibre optic system,
reveals the beauty of the pool at night.**

Afterdark offers a variety of colours that recreate and reflect a rainbow on to the water. Exceptionally long lasting (approx. 7000 hours) thanks to the new generation “Light Maximiser” lamp, Afterdark offers a huge number of light applications, more so than other fibre optic technologies on the market.

- 9 different colours
- 2 colour rotation speeds + pause
- Many applications
- “Light Maximiser” halogen lamp
- Universal fibre lenses

Its spectacular results may vary with the setting and finish of the pool or SPA.

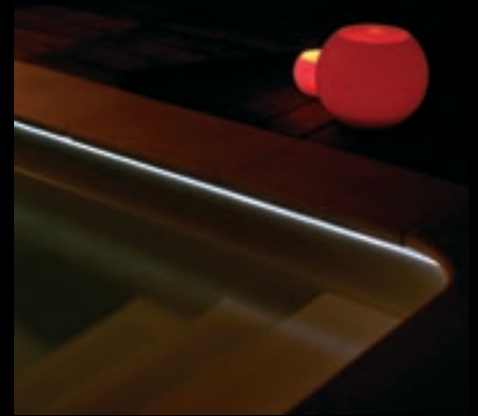
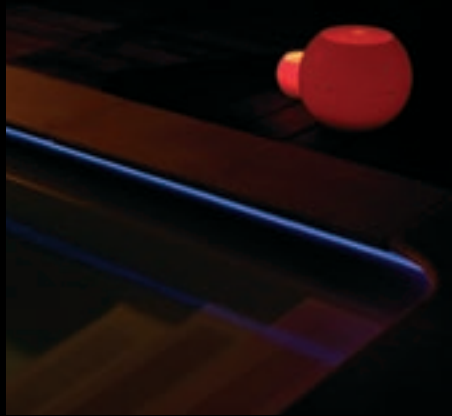
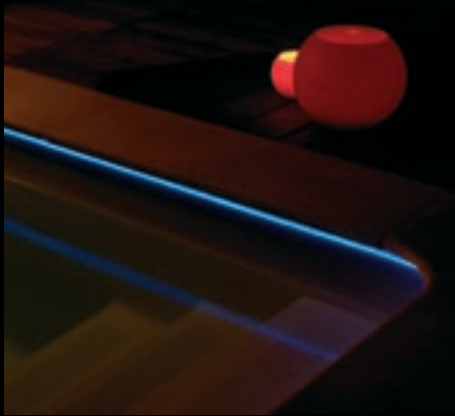

What are fibre optics?

Fibre optic cable is a very thin transparent wire that transmits a bundle of light that makes use of differences in light refraction in different settings.

With the aid of 20 to 100 Watt generator which serves as the source, the light passes through the fibre and comes out through terminations that can be simple (light comes out of the fibre normally) or more elaborate. So with prisms or strips you can create complex and attractive light features.



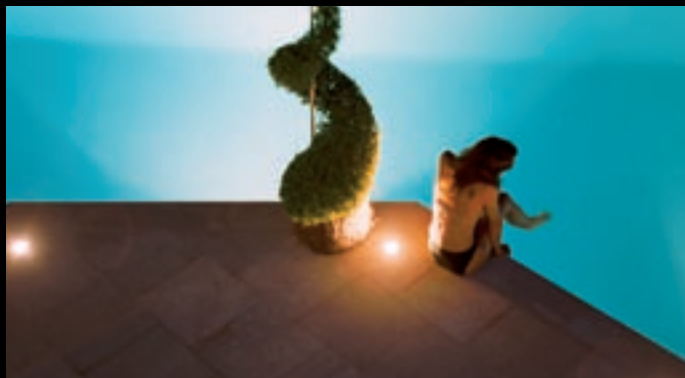

Water Design System

FIBRE OPTICS

In everyday life our mood and our vitality largely depend on the amount of light we receive throughout the day. Venerated by people, such as the Incas, light – and especially sunlight – is one of the essential elements of our existence on earth.

Since man first mastered this source of energy, the desire to make even more colourful and attractive designs has been close to his heart. With fibre optics, light technology reaches its height and makes it possible to create wonderful and personalised lighting. At first available only to scientific industries and the privileged few, the wonders of fibre optics are now within everyone's reach.

Fibre optics are synonymous with new, contemporary and innovative forms of lighting. Placed at the bottom of water jets in fountains, under floors so that only tiny pinpricks of light appear, in gardens and among plants, on the ceiling, etc. it creates magical dream atmospheres, star-studded and amazing.

In the pool and the surrounds, after dark fibre optics are a discreet way to adorn your customers' gardens with a thousand and one lights and delight both young and old.

Fibre optics are available in every colour, they can safely be used in water and the installation runs for a lifetime because there are no bulbs to change.



20
07

Water Design System

FIBRE OPTICS